



GREEN represent nature, growth, and harmony.
BLUE is a serene and calming colour that represents
intelligence, responsibility, and trust



WHY Pre-Engineered Buildings



Quick Construction time



Reduction in project cost



Space Optimal



Flexibility in Expansion



Superior Quality



Large Clear spans

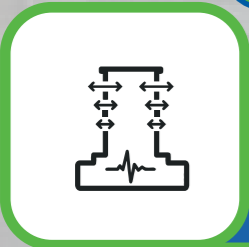

Seismic Resistant

WHY Bheemaa

Onestop Shop

End-to-End solution for PEB structure including civil work.



Capacity

1500 MT/Month, 55000 sft of Fabrication area, 150000+ sft of stock holding area.

Technology

Cost Effective Desings using **TEKLA**, **STAAD PRO**, **AUTO CAD** and **MBS**.

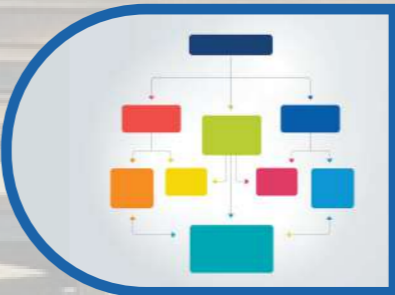

Process

Centralized tracking for every phase of project execution to bring complete transparency.

Eco-Friendly

Structures comply with at least five of eight categories described in The **LEED®** Program (US).





VISION

- Quality, reliable, timely completion and a safe working environment.
- Transparency, mutuality, and continuous learning to its employees.
- To maximize stakeholder value through continuous adoption of latest technologies, management practices, processes, and innovation.
- Committed to enhance the Quality of Life of the community.



MISSION

- Innovative and quality works.
- Deliver the projects on time, every time.
- To ensure sense of belongingness & stability to our employees.
- Efficient & Cost saving designs.
- To be part of the global green infrastructure growth.



VALUE

- Operate business with high levels of integrity and transparency.
- Inculcate quality culture at all levels.
- Ethical business practices.
- Collaborative and creative work environment.
- Caring culture towards employees and society.
- Mutual Respect and Dignity of individuals.



OHSE (Occupational Health, Safety & Environmental)

- Comply with Occupational Health, Safety & Environmental policy.
- Apply practices and technologies to avoid occupational and health risks.
- Make continuous improvements to prevent environmental pollution and property damages.



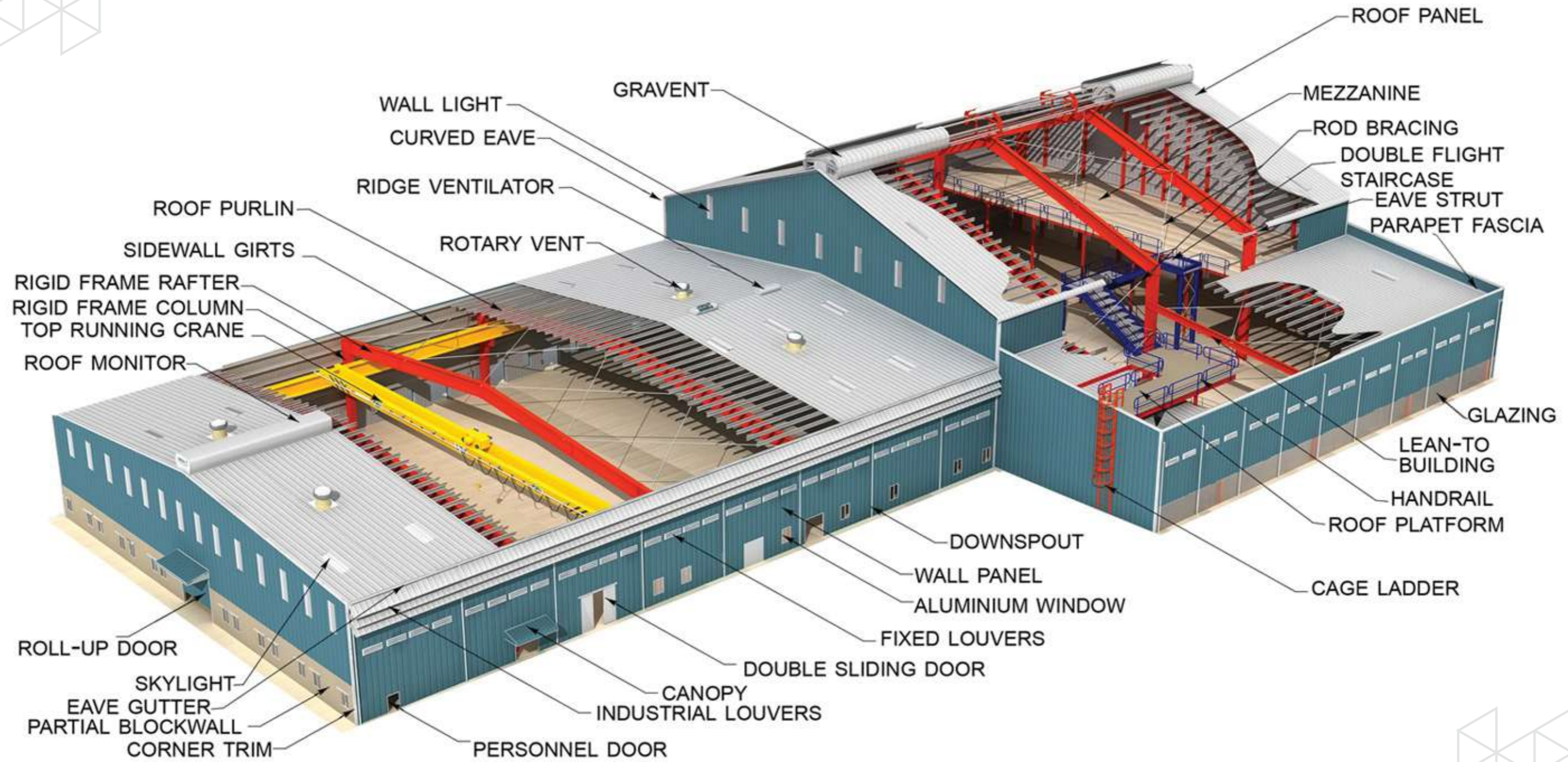

Primary Structures

Clear Span with Crane

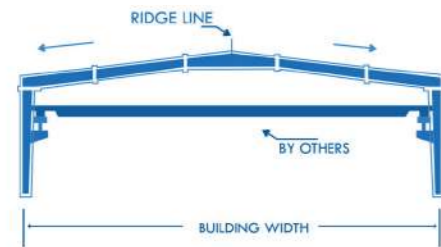

Lean-To

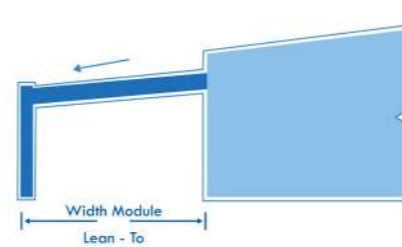

Multi Span II

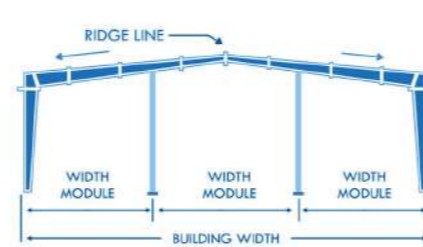

Multi Span III

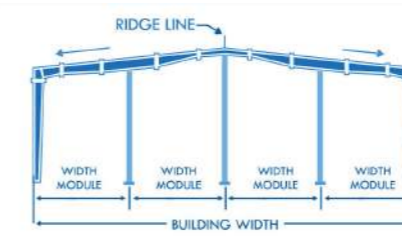

Rafter System

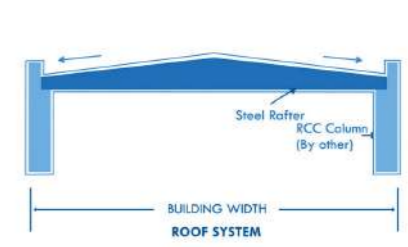

Mono Slope

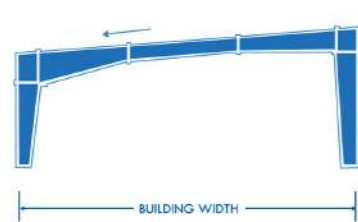

Multi Span I

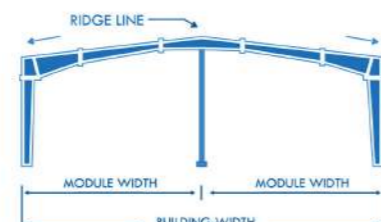

Multi Span With Crane and Mezzanine

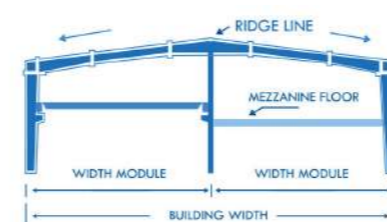

Mutli Gable (MG) I-II

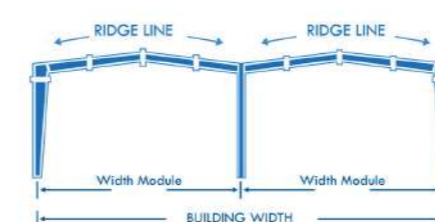

Tapered Column Clear Span (TCCS)

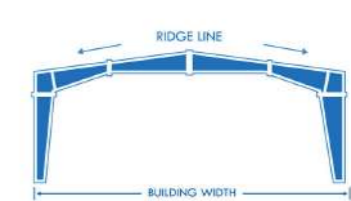

Secondary Structures

Cold Formed Sections

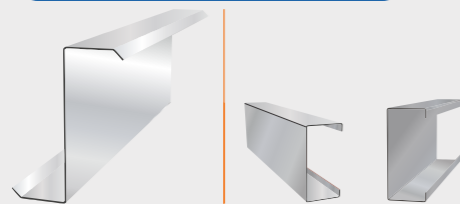

Profile: C & Z Sections
Thicknesses: 1.5 - 3.0 mm
Depth: 150mm - 300mm
Standard Finish: Pre-galvanized 120 / 275 gsm.

Cable Bracing



Wall Girts

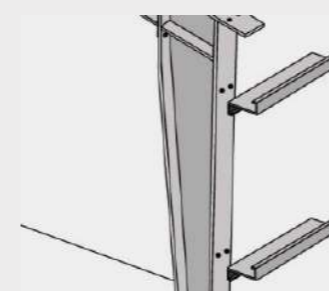

Eave Struts



Building Additions

Mezzanine Joist Connection to Mezzanine Beam

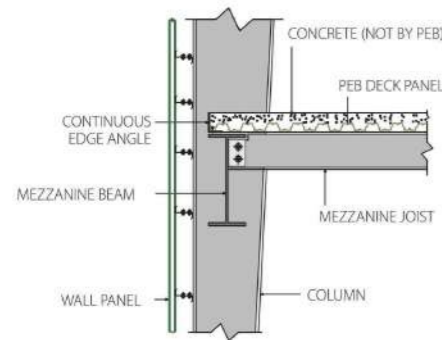

Canopy

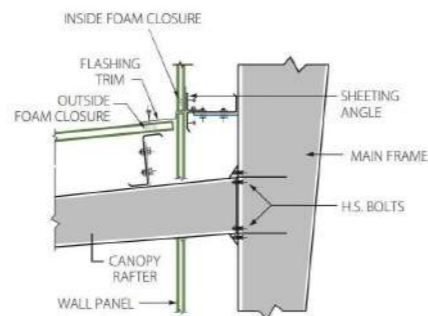

Parapet Fascia

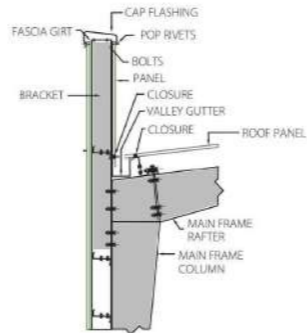

Sidewall Roof Extension

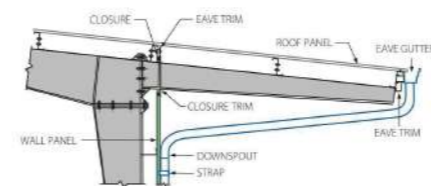

Mezzanine Beam Connection to Main Frame Column

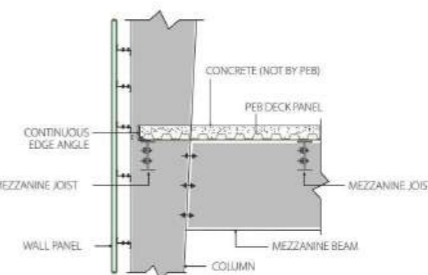

Roof System With Insulation

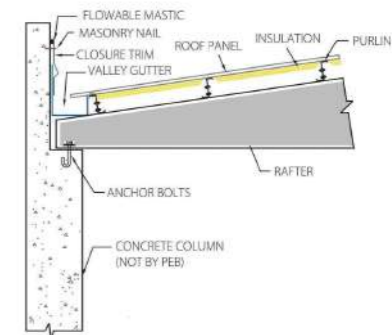

Building Accessroies



Hi-Rib Profile



Decking Sheet

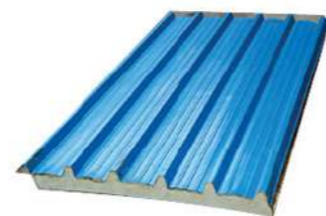

PUFF Roof Panel

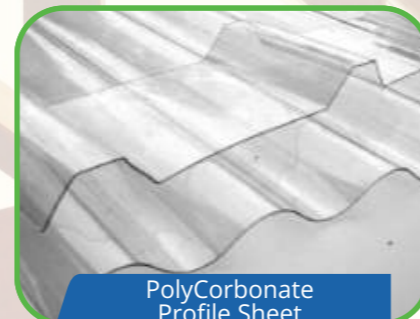

PolyCarbonate Profile Sheet



Puff Wall Panel



Standing Seam



Insulation



Aluminium Louvers



Turbo Ventilators

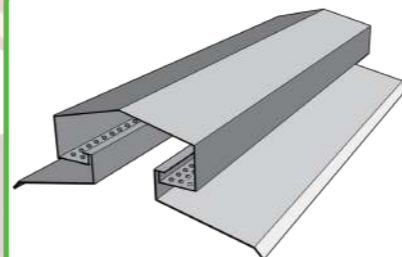

Ridge Ventilator



Self Drilling Screws

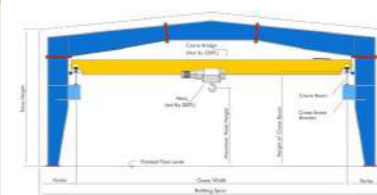

Top Running Crane

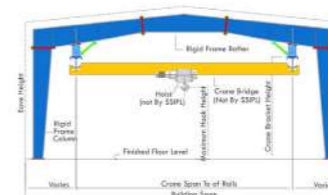

Under Hung Crane

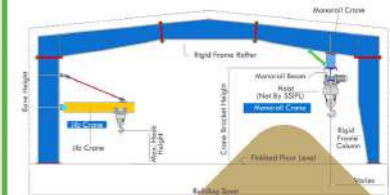

JIB and MonoRail Crane

PEB Applications



Warehouses



Ginning Mills



Convention Centers



Dairy Farms



PEB Villas



Highrise Buildings

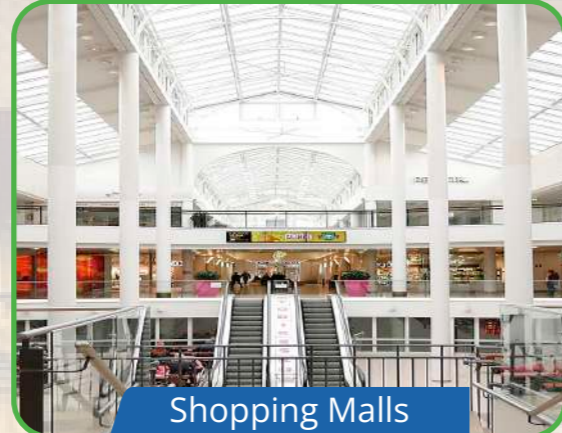

Shopping Malls



Drive-In



Railway Workshops



Bridge Griders

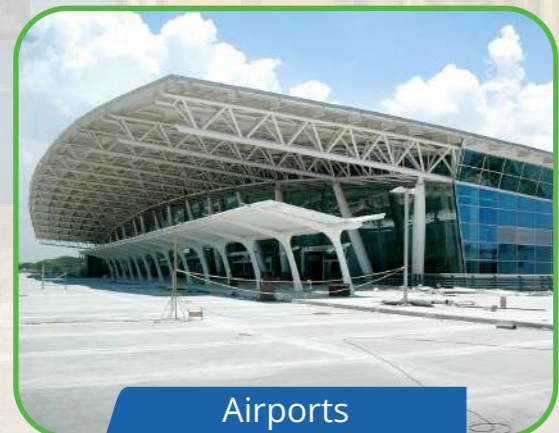

Airports

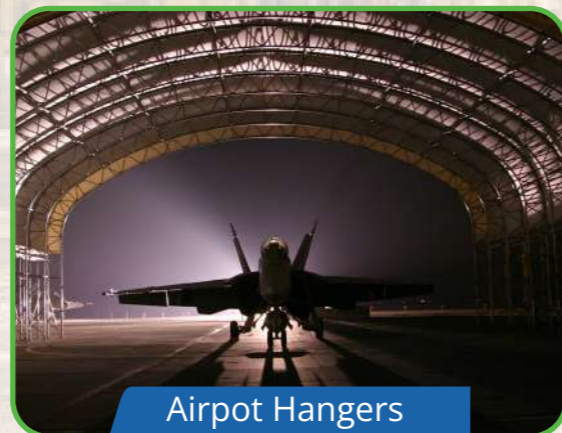

Airpot Hangers

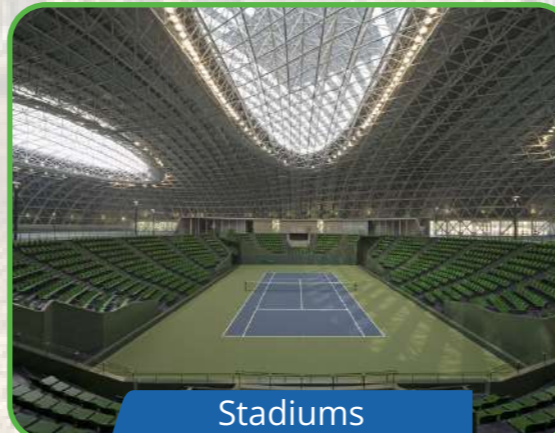

Stadiums



Cement Industries



Heavy Industries



QUALITY is our Obsession, Passion and Guarantee

BHEEMAA

Infra Solutions Pvt. Ltd.

📍 **Admin Office:** #304, SriNilayam, Calvary temple road,
Matrusri nagar, Miyapur, Hyderabad, Telangana -
500049

📍 **Manufacturing Plant:** Survey#323, Konapur Village,
Sadasivapet (M), Sangareddy (D), Telangana - 502291

Phone : 040 40178889 | Email : Info@bheemaa.com | WebSite : www.bheemaa.com