



GREEN represent nature, growth, and harmony.
BLUE is a serene and calming color that represents intelligence, responsibility, and trust.

CORPORATE PROFILE



20+

Years of collective
PEB Experience

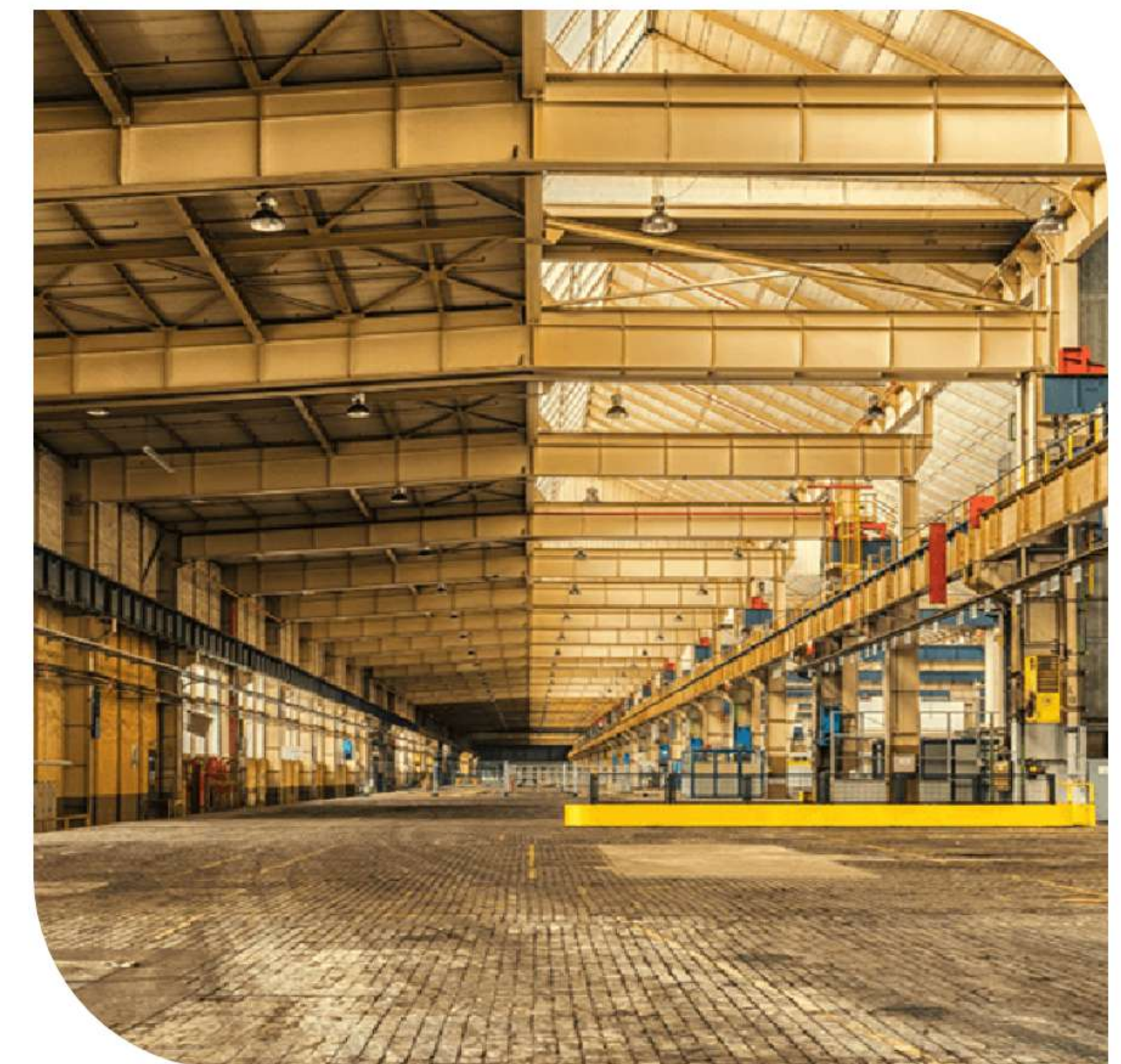

55k+ Sqft

Of Manufacturing
Facility

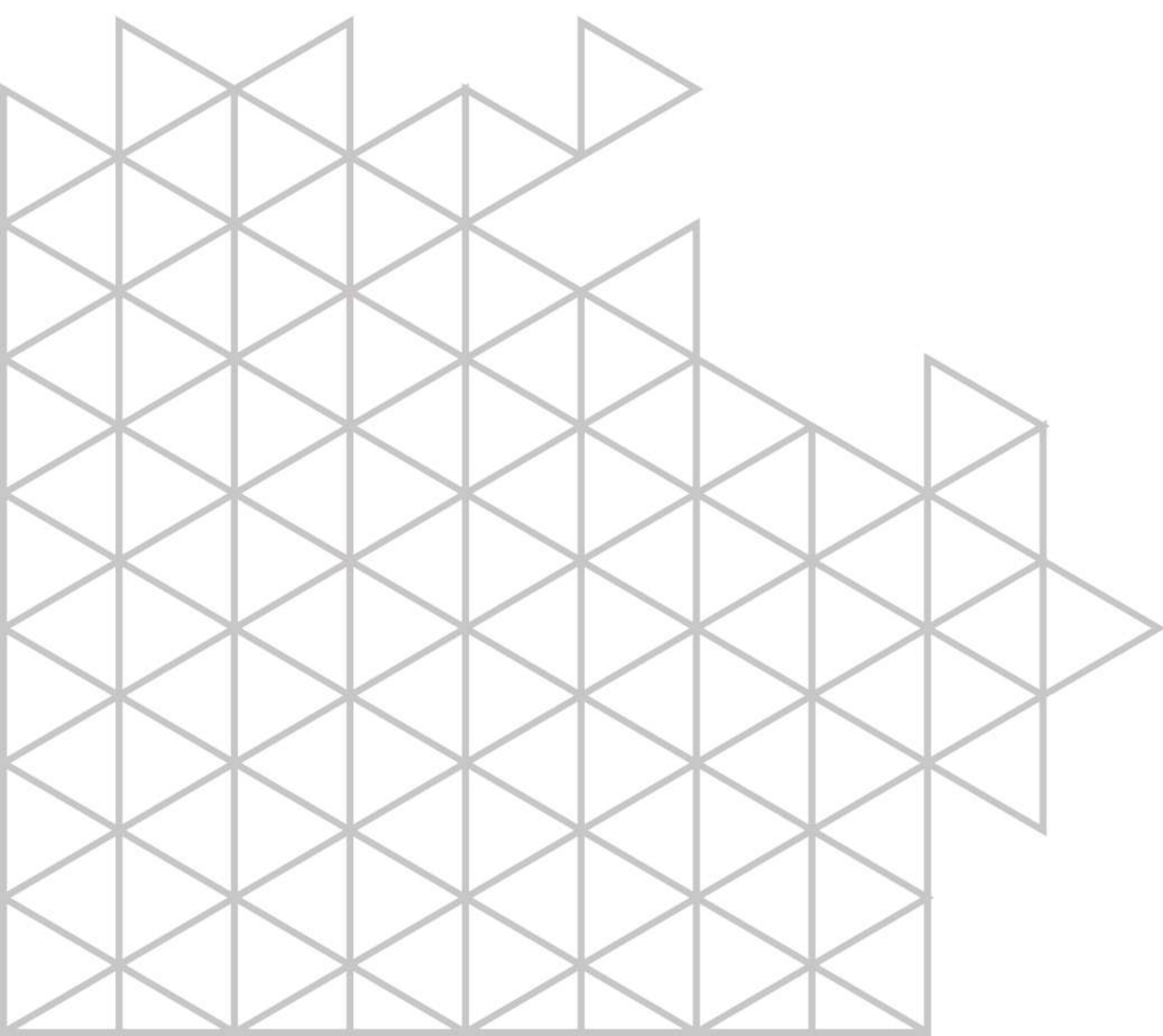

OUR VISION & MISSION



OUR VISION

- ★ Quality, reliable, timely completion and a safe working environment.
- ★ Transparency, mutuality, and continuous learning to its employees.
- ★ To maximize stakeholder value through continuous adoption of latest technologies, management practices, processes, and innovation.
- ★ Committed to enhance the Quality of Life of the community.



OUR MISSION

- ★ Innovative and quality works.
- ★ Deliver the projects on time, every time.
- ★ To ensure sense of belongingness & stability to our employees.
- ★ Efficient & Cost saving designs.
- ★ To be part of the global green infrastructure growth.



OUR VALUES

- ★ Operate business with high levels of integrity and transparency.
- ★ Inculcate quality culture at all levels.
- ★ Ethical business practices.
- ★ Collaborative and creative work environment.
- ★ Caring culture towards employees and society.
- ★ Mutual Respect and Dignity of individuals.



H-BEAM WELDING LINE

- ★ Pre-Engineered Beam Fabrication.
- ★ Plate to Beam Conversion.
- ★ Structural Beam Welding.
- ★ Railway Beam Fabrication / welding
- ★ Automatic SAW Beam Welding
- ★ High Rise Beam Welding
- ★ Fabrication
- ★ Crane Beam Welding

HYDRAULIC SHEARING

Has upto 16mm Shearing capacity.



CNC PLASMA AND MULTI TORCH OXY FUEL

Can cut higher thickness of metal sheets up to 20mm on plasma and up to 50mm on oxy fuel.



EOT CRANES

3MT Gantry Crane, Two - 5MT and Two - 10MT EOT cranes for material handling.

WE ARE ALSO EQUIPPED WITH

- ★ Essab Saw Welding Machine CPRA 1250i
- ★ Kitchen & Wade Radial Drilling Machine
- ★ HMT RM 50 Radial Drilling Machine
- ★ Csepel Radial Drilling Machine
- ★ Lincoln MIG Welding Machine 400 i
- ★ Esaab ARC 400I Welding Machine
- ★ Bosch AG-4 and AG-7
- ★ Escort Hydra 14ton Capacity
- ★ Synco Sand blasting hooper
- ★ Jaguar airless paint spary machines
- ★ Broach Cutters
- ★ CP Air compressor 40HP 204 CFM@7.5 bar
- ★ CP Air compressor 7.5HP 21 CFM@10 bar
- ★ Bench Grinder
- ★ QDO 300 portable oven
- ★ Essae Weighbridge with 100 MT Capacity

MANUFACTURING UNIT

55000+ Sqft.

55000+ Square feet of fabrication Area.



2 Lakhs+ Sqft.

2 lakhs+ Square feet of stock holding Area.

15000+ MT/ Year.

Fabrication capacity over 15000+ MT/Year.



OUR PRODUCTS

PRIMARY STRUCTURES

Multi Span III

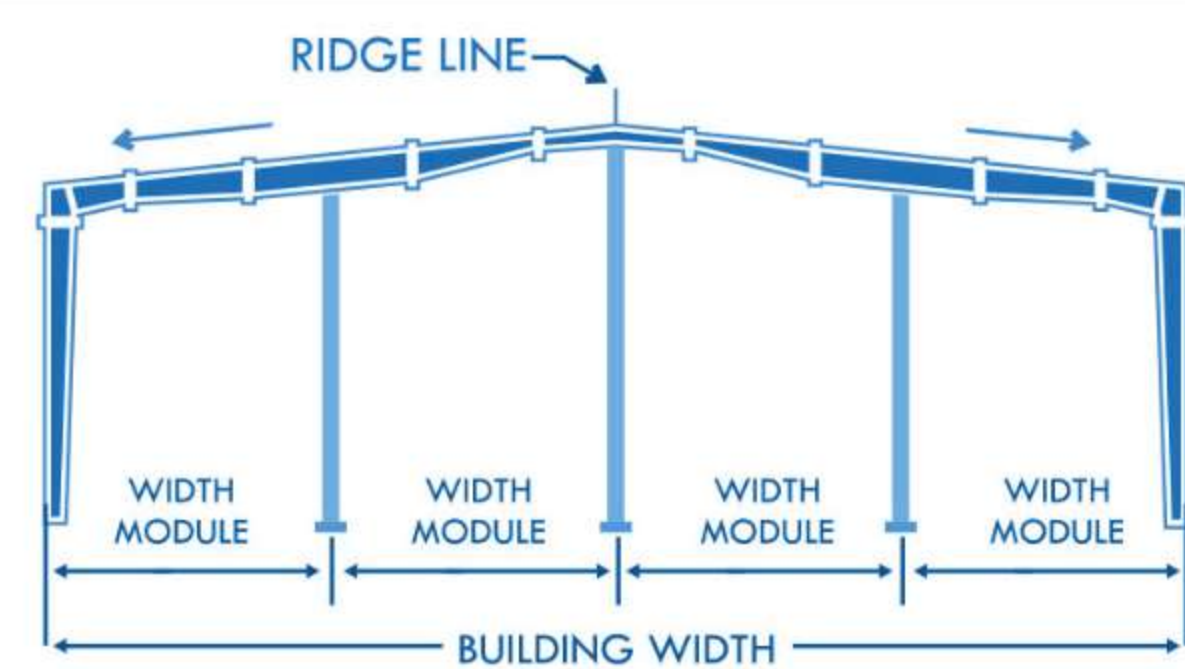

Clear Span with Crane

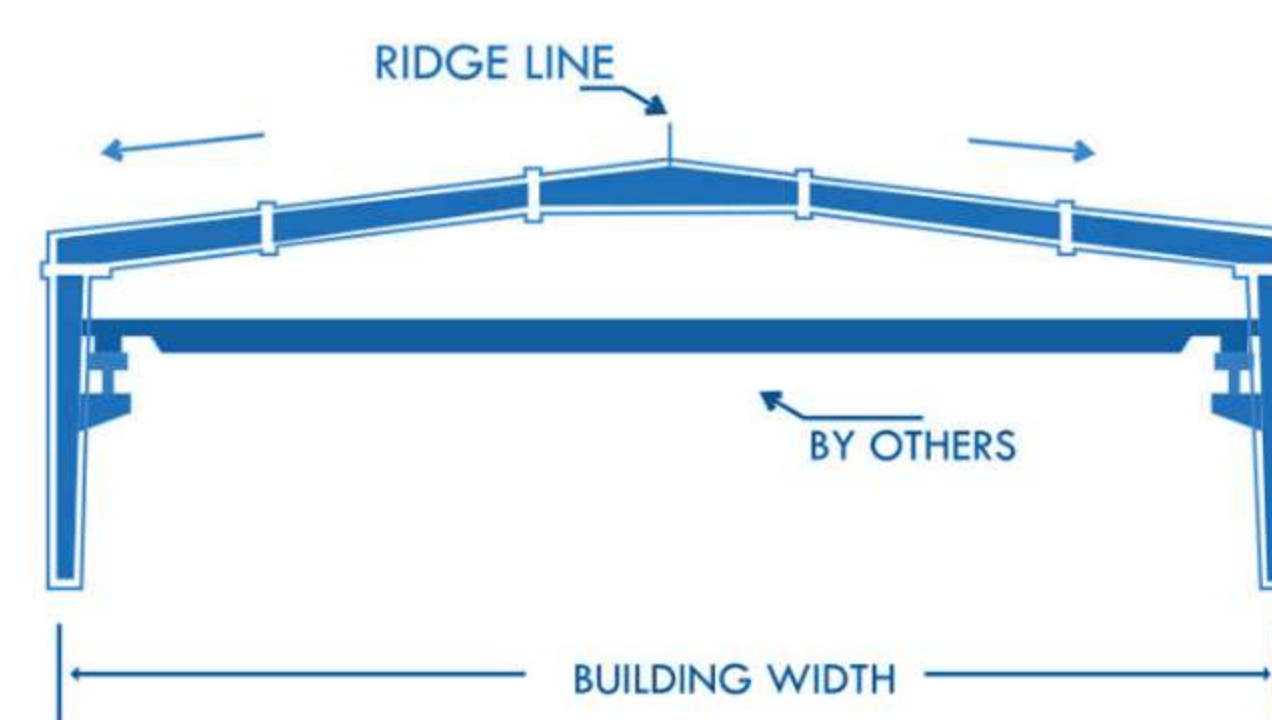

Lean-To

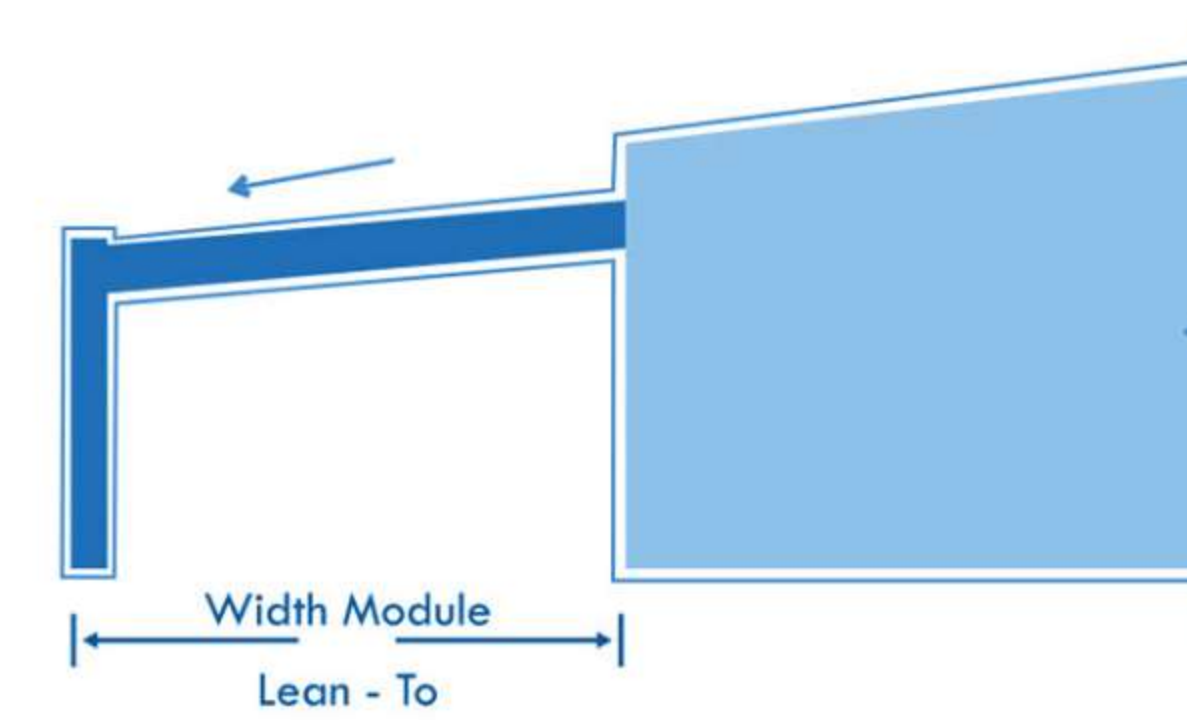

Multi Span II

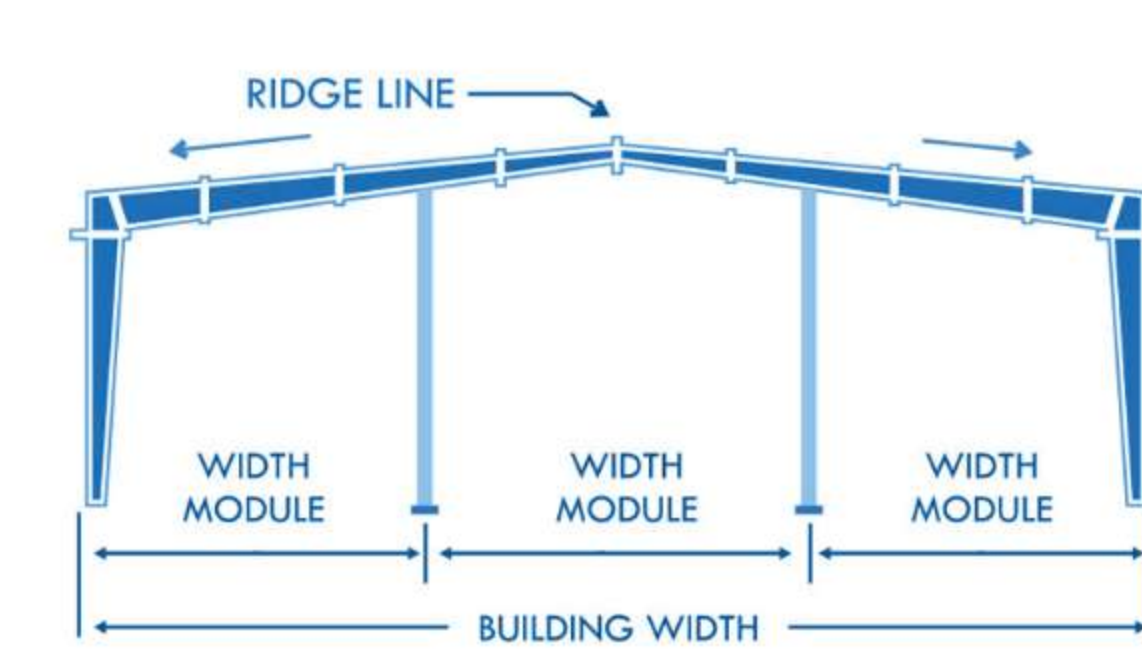

Mono Slope

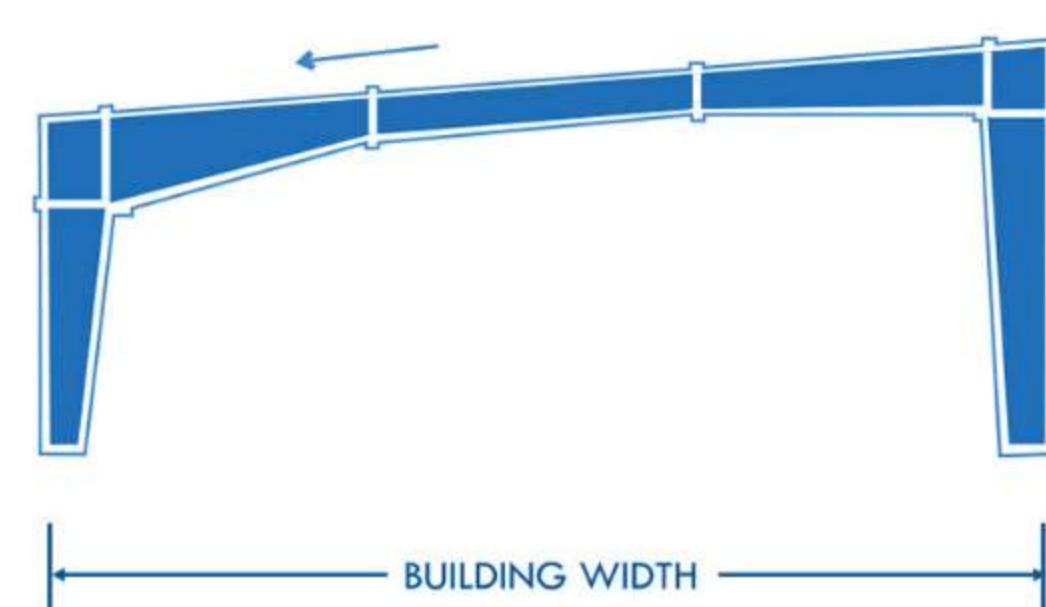

Multi Span I

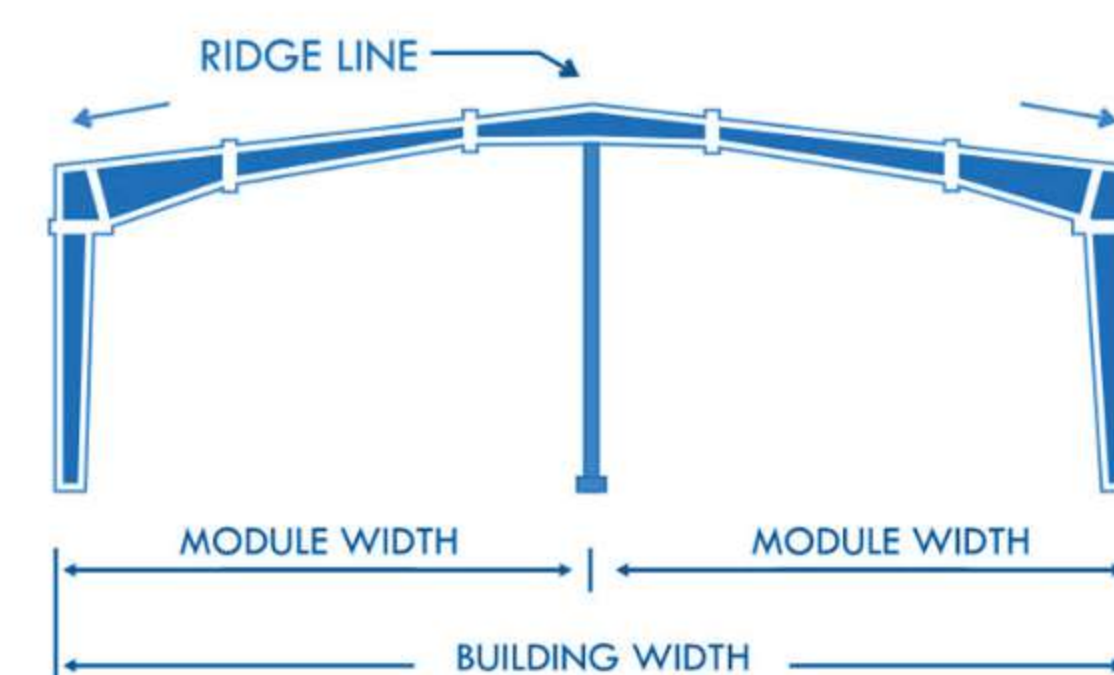

Multi Span With Crane and Mezzanine

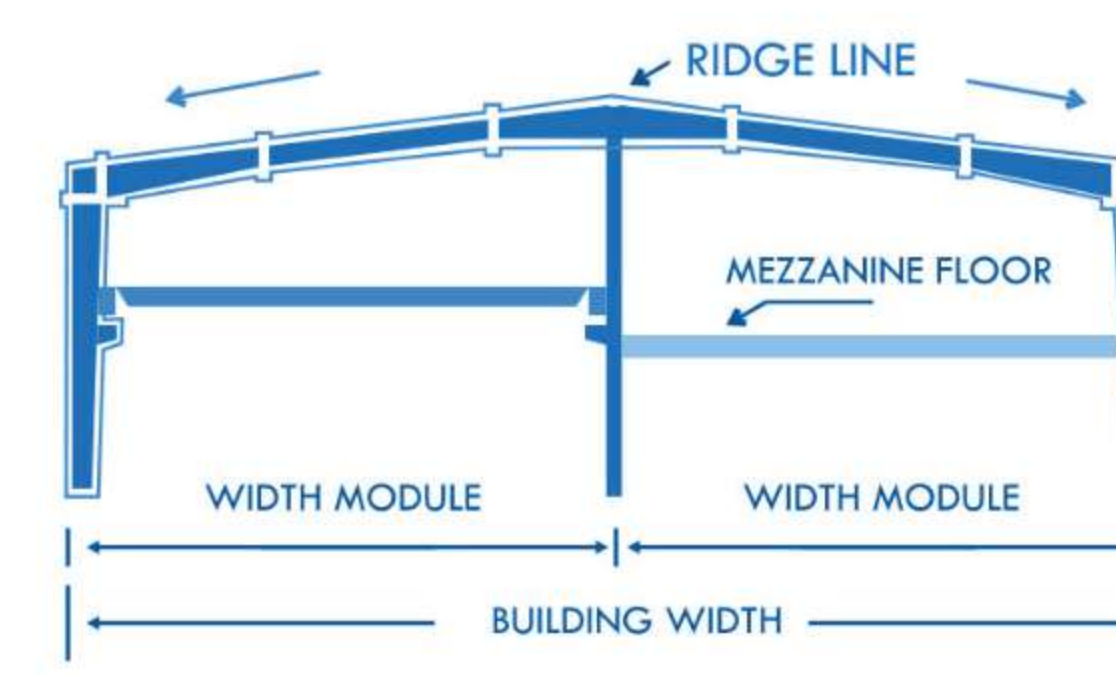

Mutli Gable (MG) I-II

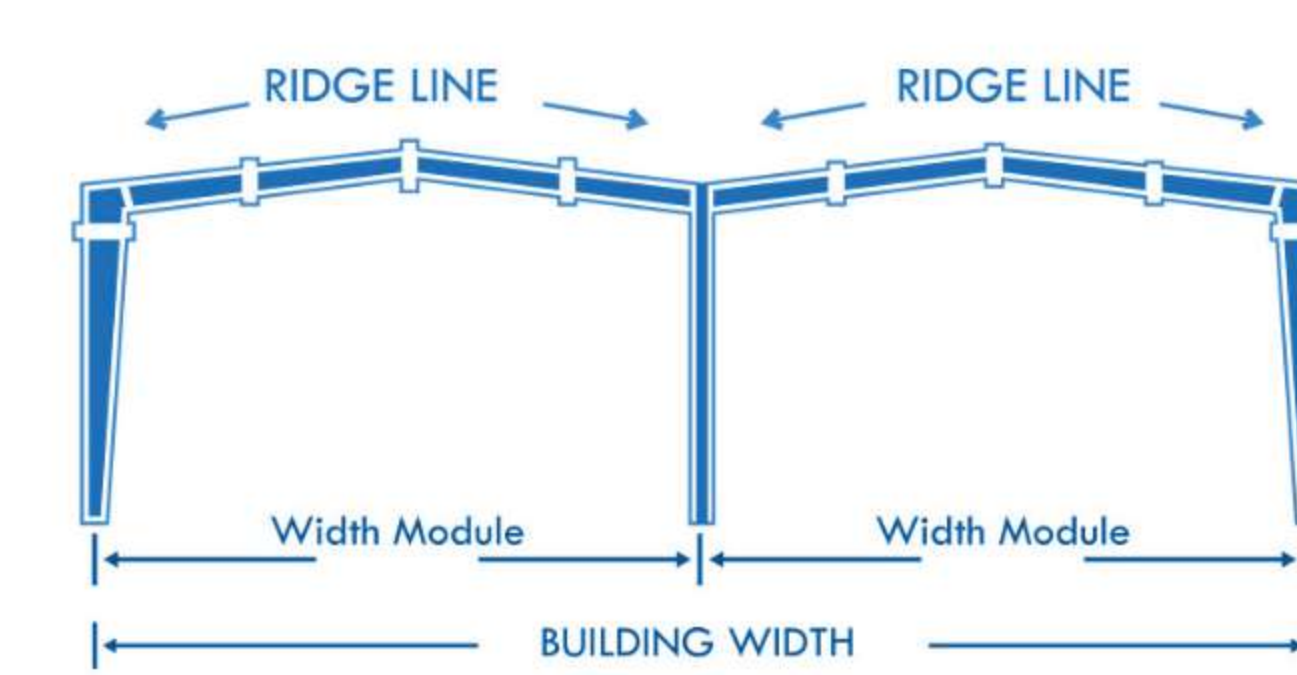

SECONDARY STRUCTURES

Cold Formed Sections

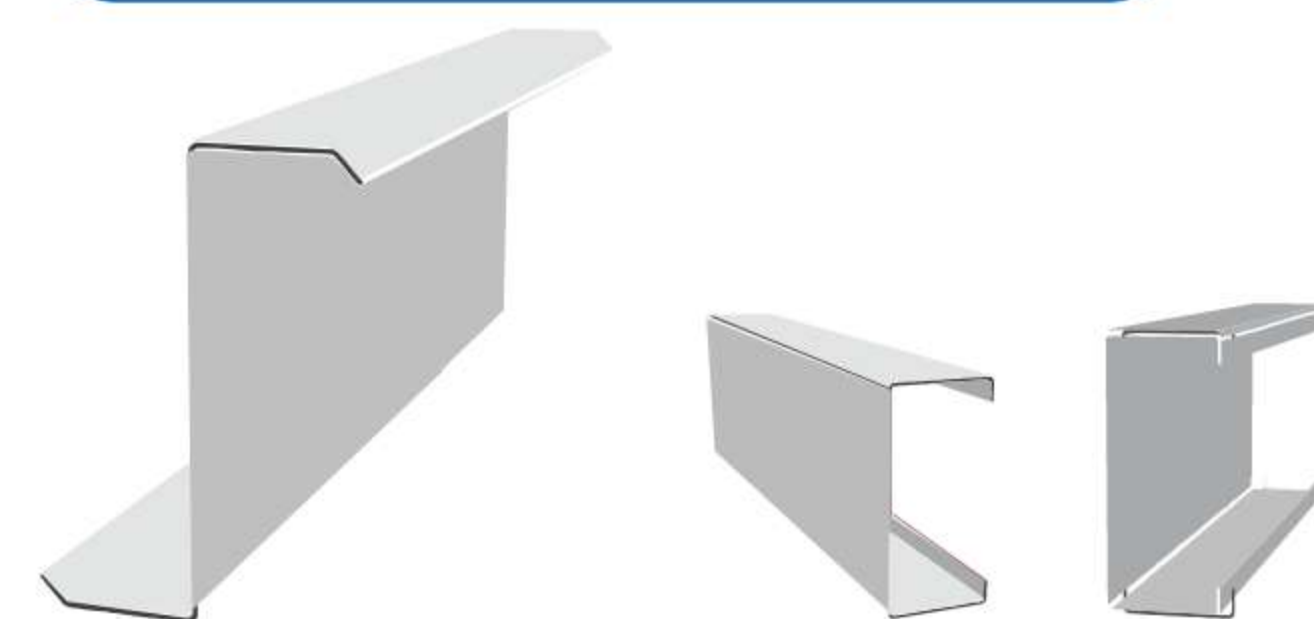

Profile: C & Z Sections
Thicknesses: 1.5 - 3.0 mm
Depth: 150mm - 300mm
Standard Finish: Pre-galvanized 120 / 275 gsm.

Cable Bracing



Eave Struts



OUR PRODUCTS

BUILDING ADDITIONS

Canopy

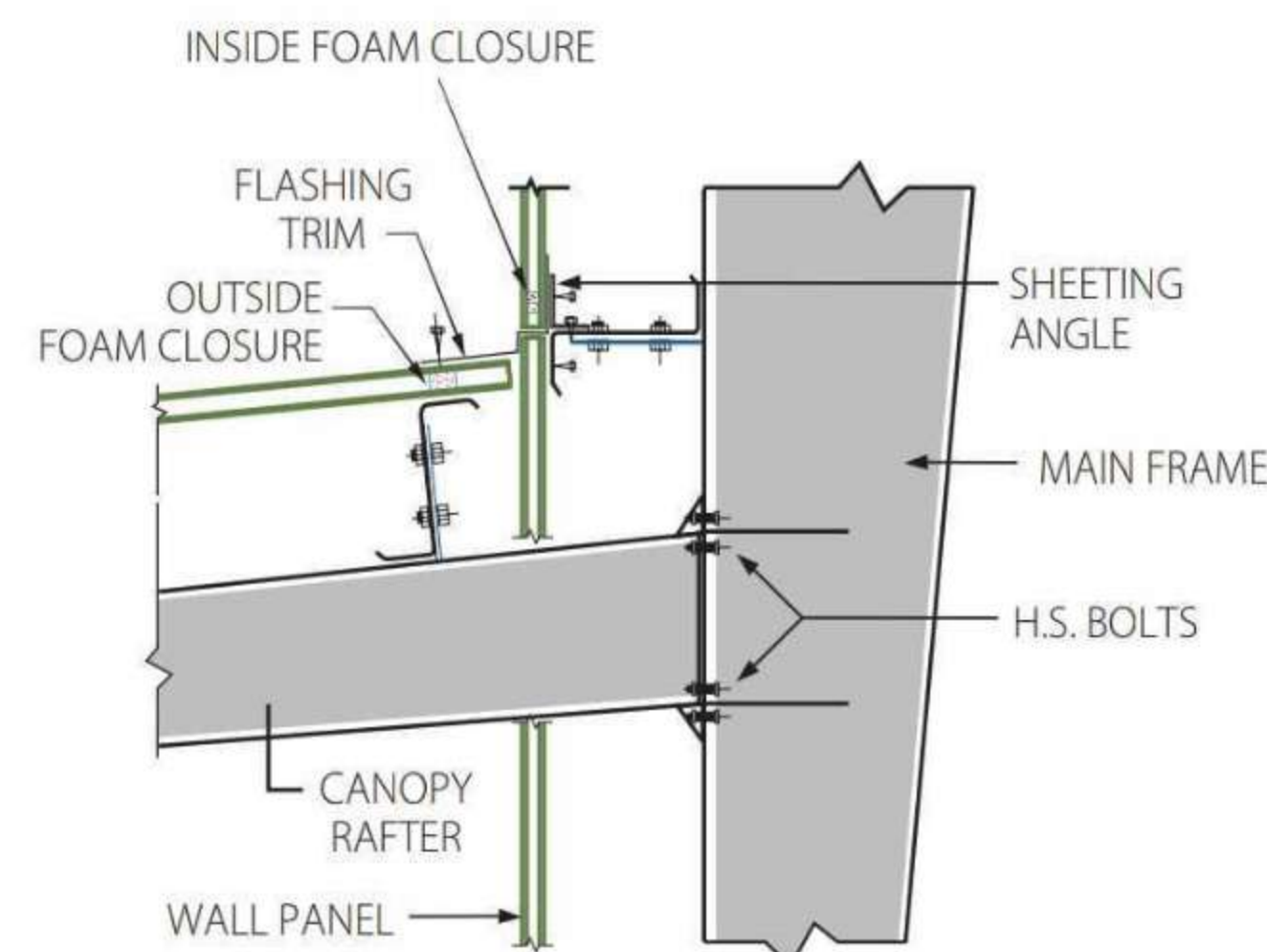

Sidewall Roof Extension

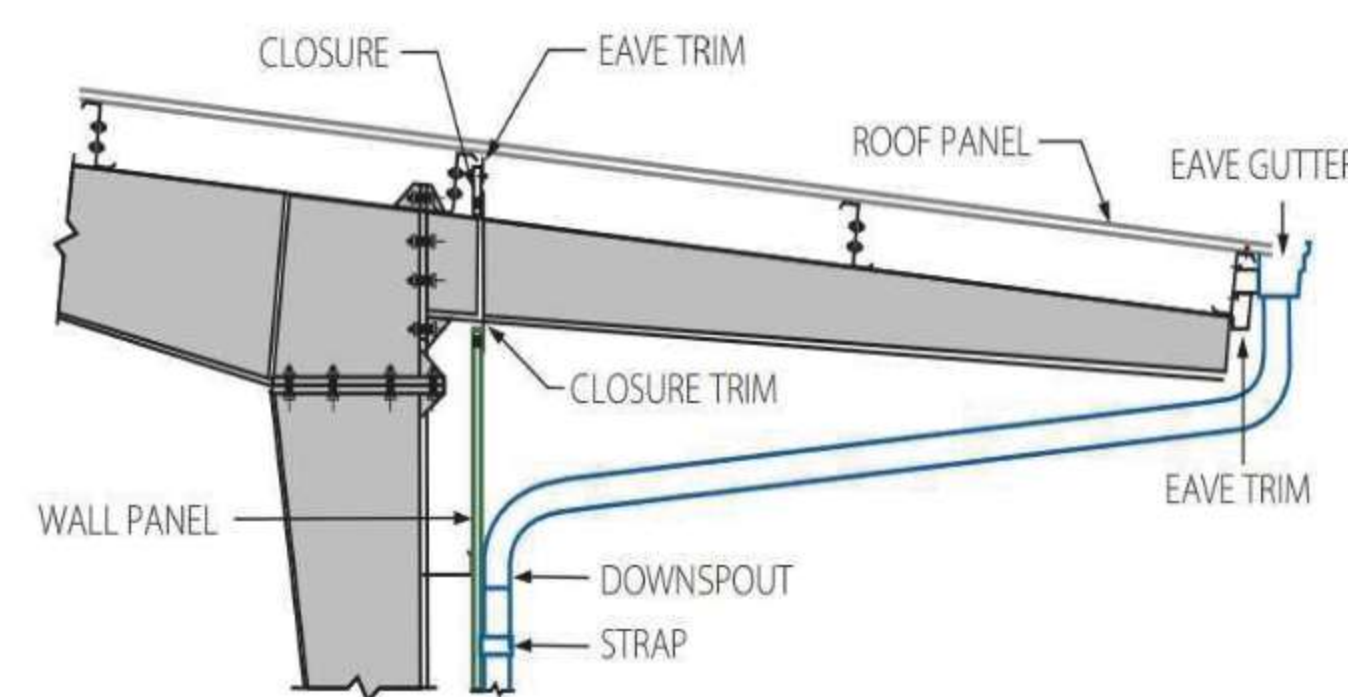

Mezzanine Beam Connection to Main Frame Column

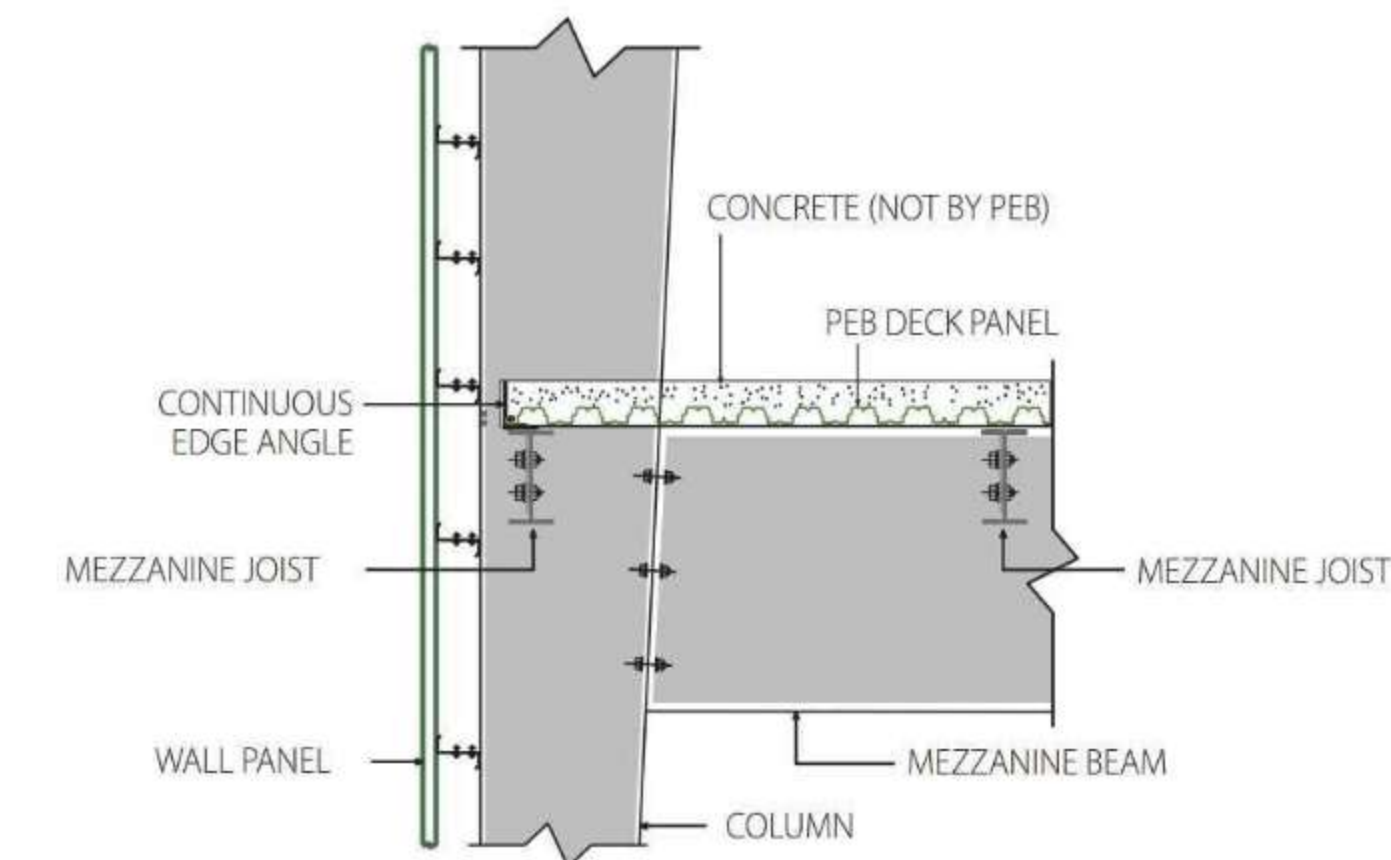

Roof System With Insulation

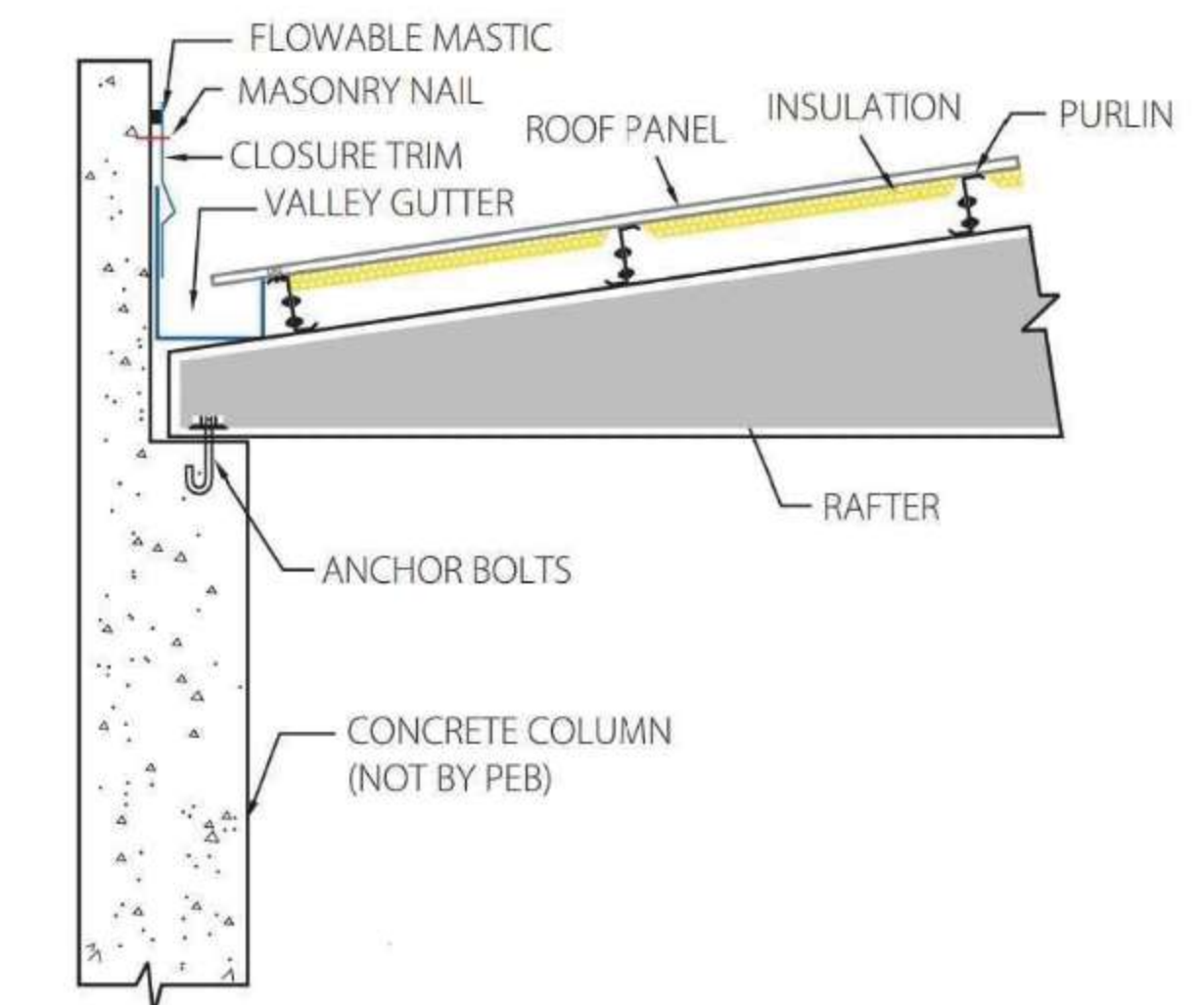

BUILDING ACCESSROIES



Hi-Rib Profile



Decking Sheet

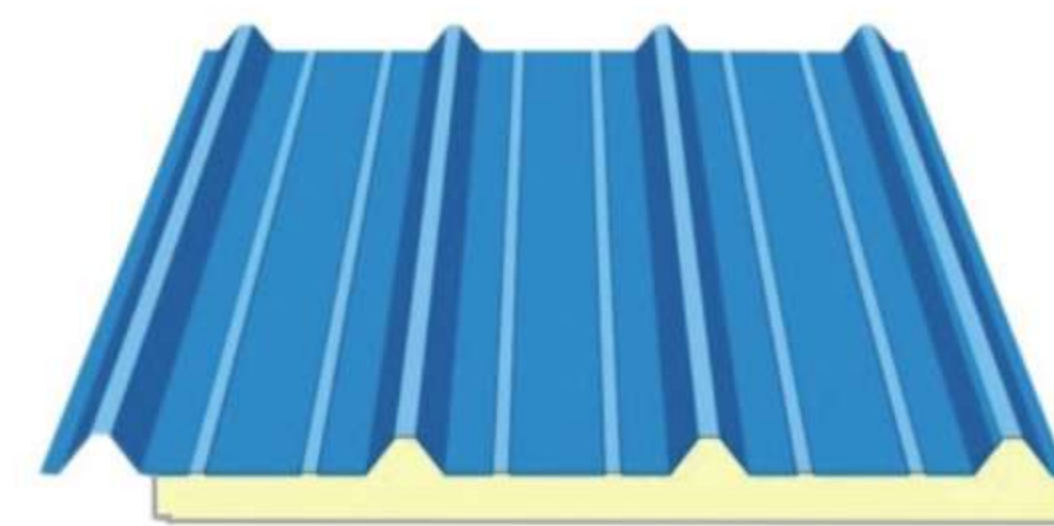

PUFF Roof Panel



PolyCarbonate Profile Sheet



PUFF Wall Panel

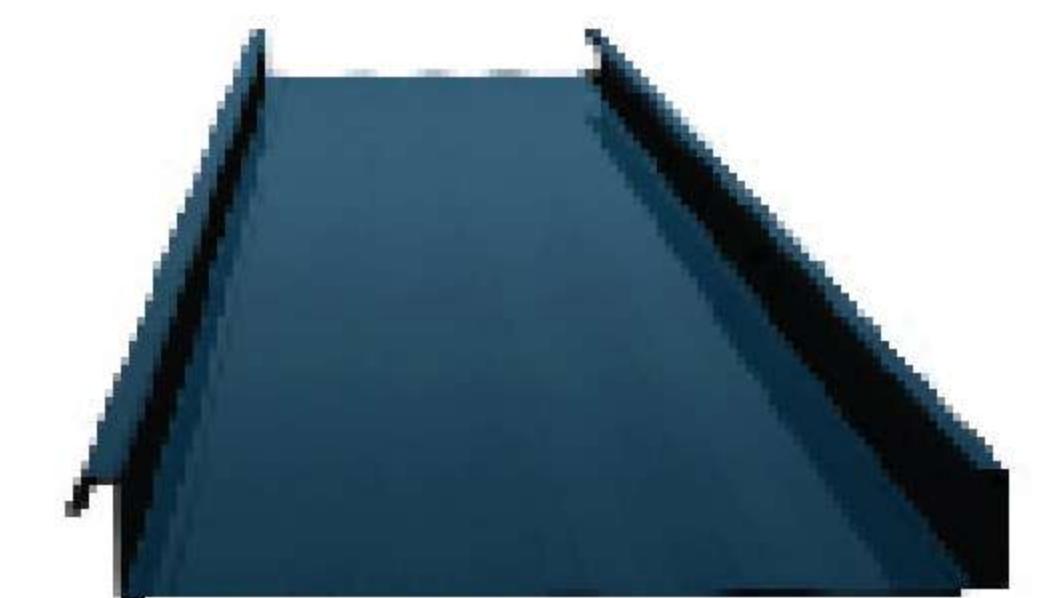

Standing Seam



Insulation



Turbo Ventilators



Aluminium Louvers

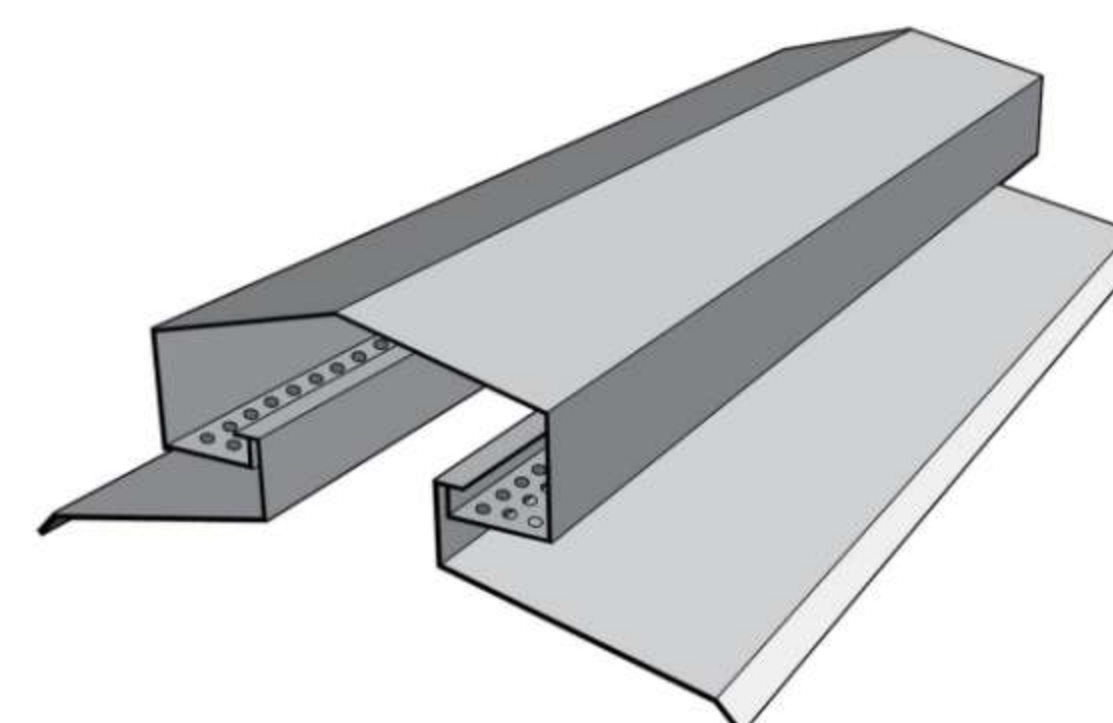

Ridge Ventilator



Self Drilling Screws

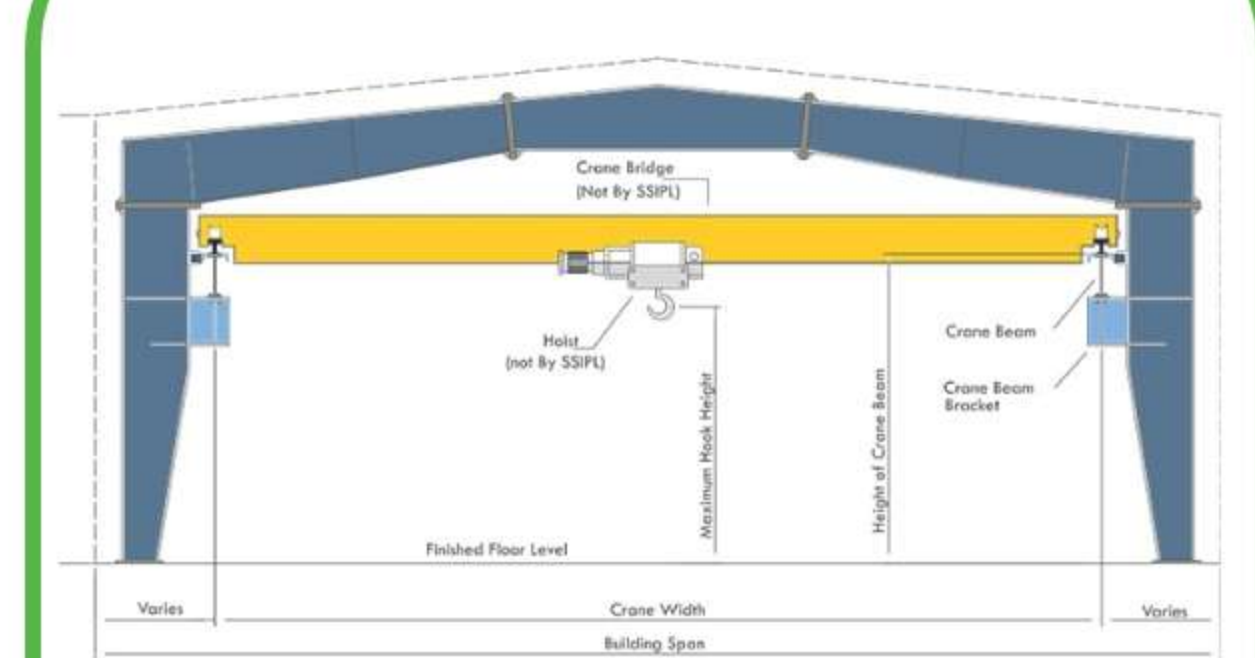

Top Running Crane

OUR UNIQUENESS



Bheemaa Infra Solutions Pvt.Ltd is best of both the worlds combined from **CIVIL** and **PEB**. So, we are offering an end to end solution from CIVIL works to PEB to our customers using our unmatched experience and knowledge in the both fields. So, we are One Stop Shop for our customers in related to PEB structures.

OUR UNIQUENESS

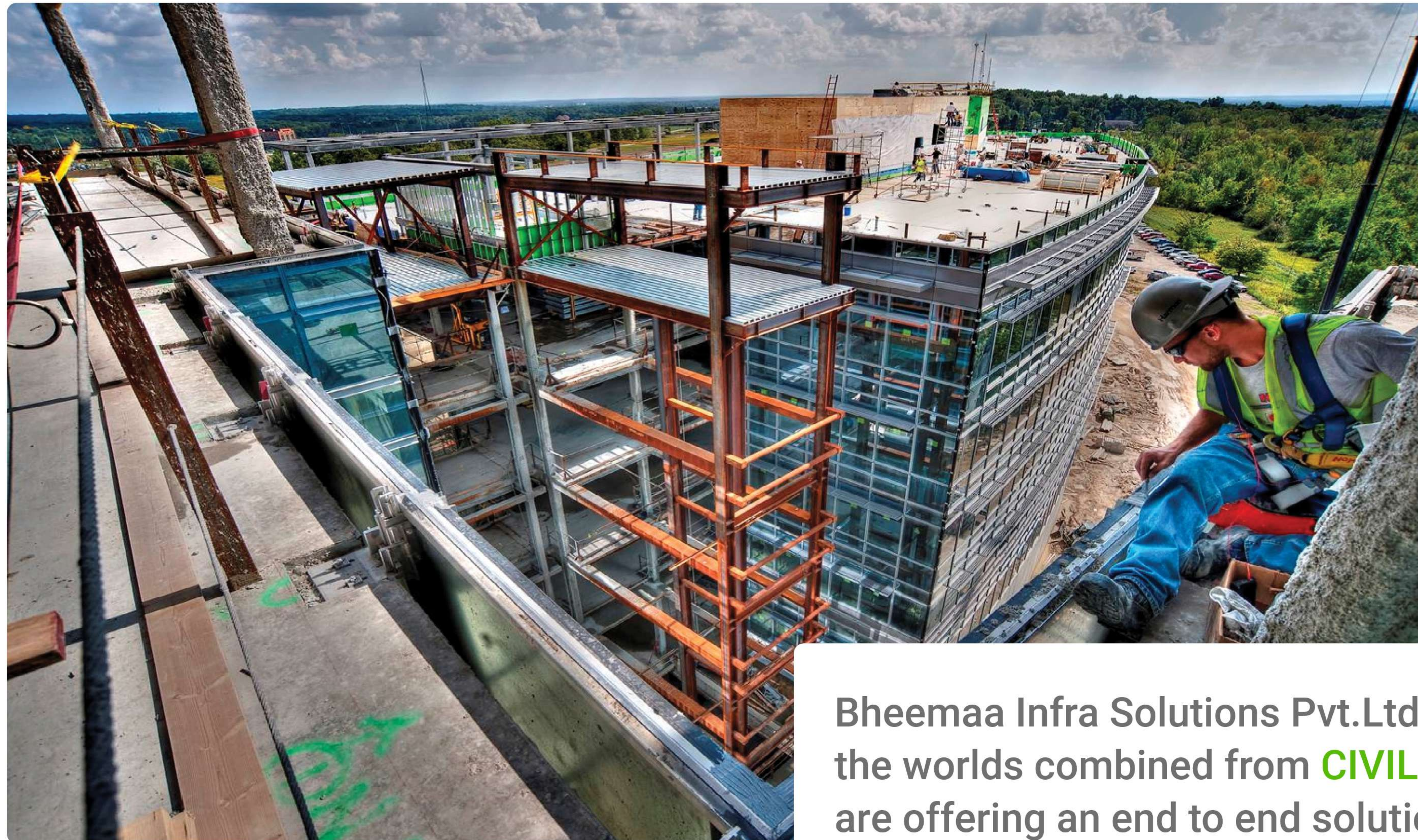

Bheemaa Infra Solutions Pvt.Ltd is best of both the worlds combined from **CIVIL** and **PEB**. So, we are offering an end to end solution from CIVIL works to PEB to our customers using our unmatched experience and knowledge in the both fields. So, we are One Stop Shop for our customers in related to PEB structures.

EXECUTIVE TEAM



MR. SEETHARAM CH

Managing Director

+17 YEARS of Total experience which includes +7 years as managing partner of CSR Infra and as part of the company he worked with major Pharma and industrial constructions.



MR. S.V.V PRASADA RAO

Director

+25 YEARS of experience as a managing partner of Sri Lakshmi constructions and as part of the Company he worked for all major pharma companies and industrial constructions.



MR. SRINIVASA RAO CH

Director - Sales & Marketing

+25 YEARS of Total experience in various positions in the steel industry. +22 Years experience in marketing and +10 years of experience in PEB industry which involve Procurement, production, and installation of



MR. RAMBABU G

Sr.GM - Sales & Marketing

+15 YEARS in PEB Industry, completed ME in IME Bombay, worked in PEB industry in Design and sales, Associated with Kirby, Pennar and middle East with senior positions.



MR. RAVI M

Head – Project Management

+20 YEARS of experience in Kirby, Tata BlueScope, Aster PEB Steel and gained well-versed knowledge in manufacturing, project management and client co-ordination. Mr. Ravi is graduated as mechanical engineer.



MR. SAMMAD A

Head – Manufacturing

+12 YEARS of experience in PEB industry. He Worked in +7 years in Oman as a production engineer and gained well versed knowledge of all aspects at PEB like planning, production, dispatch etc. Mr. Sammad graduated as Mechanical engineer.